



Assembly manual

for joined/ connected units

Connection on *long side*



Tools needed

For connecting/ joining the units



Spanner keys



Screw driver for cross head screws



Drill bit



Crowbar

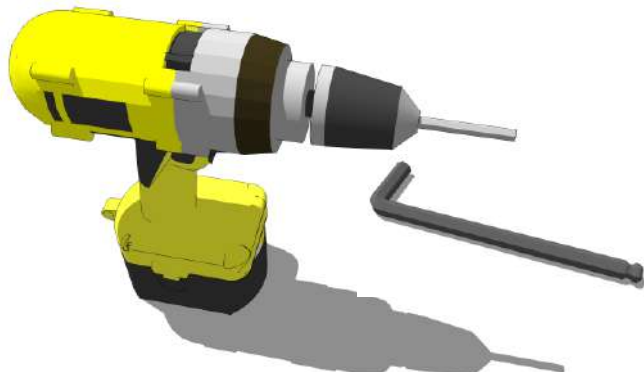

High speed drill with 14mm allen key



Rubber Hammer



Rubber gloves



External **Connection kit set**

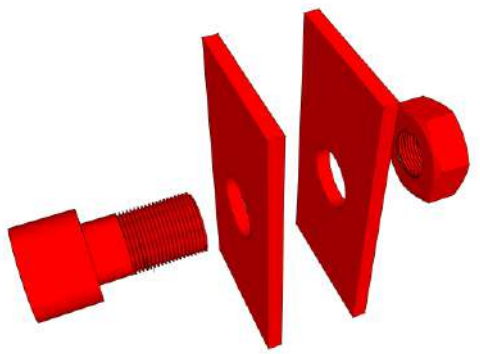

**Horizontal
Connection plate**

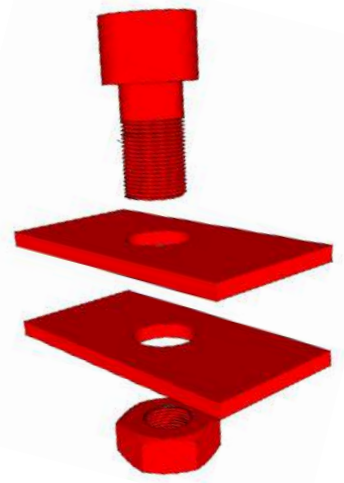

**Vertical
Connection plate**

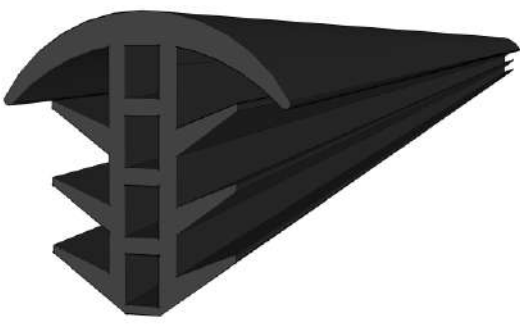

Gasket/ sealing rubber



Internal Connection kit set

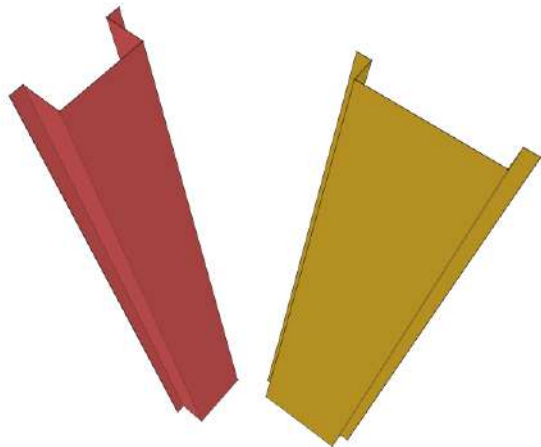

Vertical flashings to cover corner posts connections/ joints

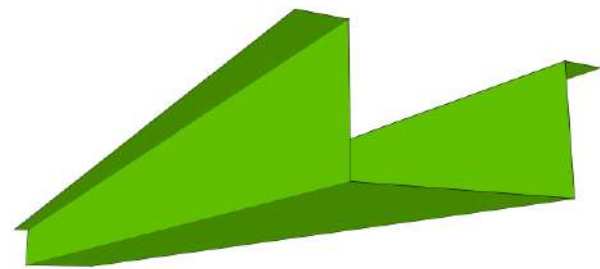

Ceiling flashing to cover Roof frame connections/ joints



Plywood strip floor filler

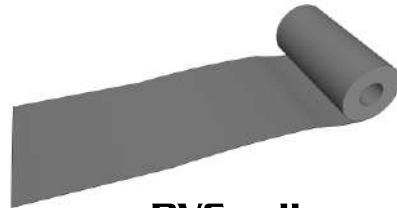

PVC roll floor strip

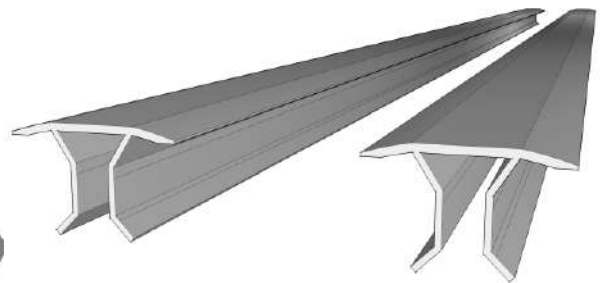

Aluminum floor connector trim



Connection on long side

External side

Position the flatpack containers in location. You can use a crowbar to adjust the alignment of the containers

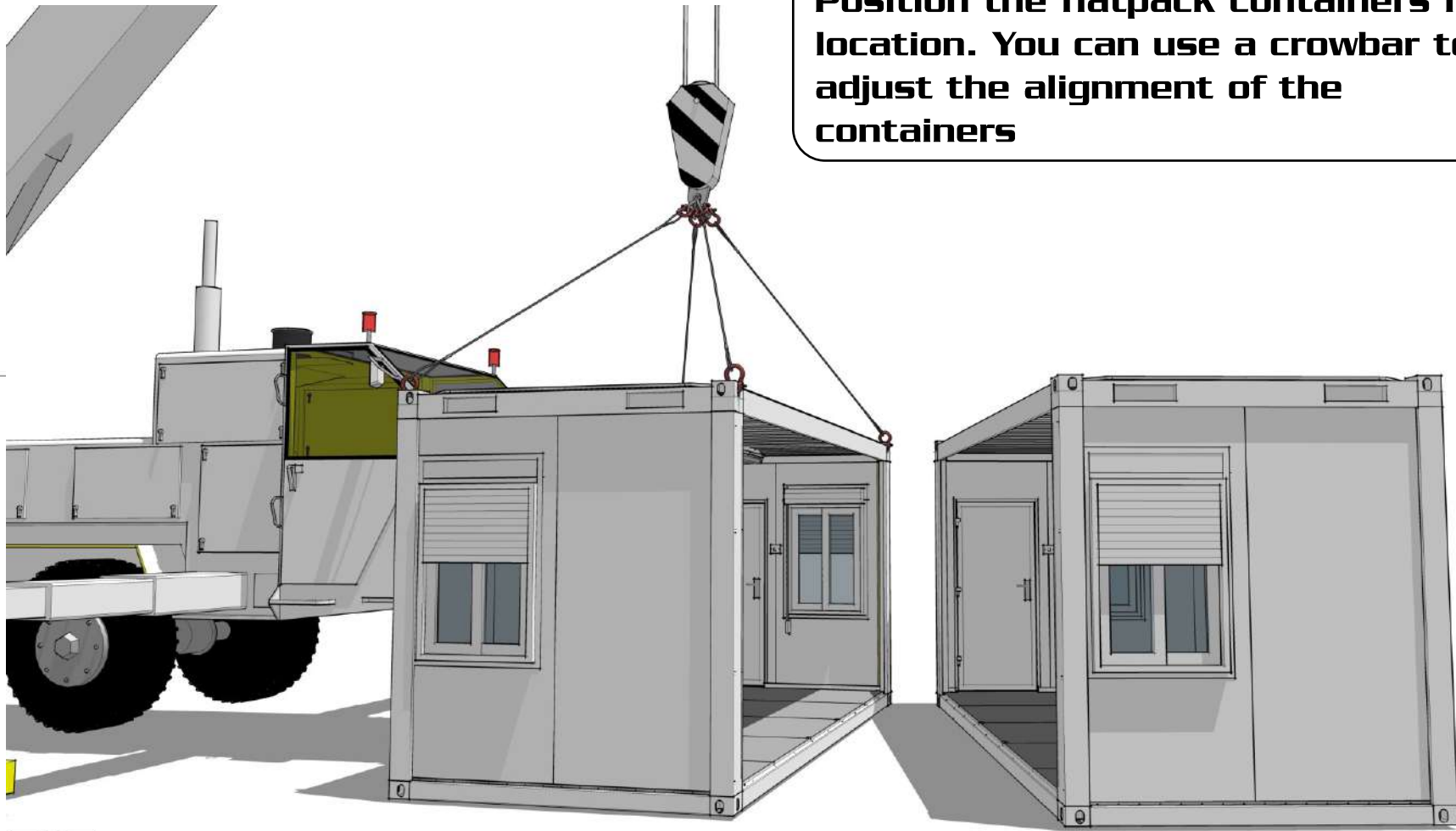

1 2 3 4 5 6 7 8

A

B

C

D

E

F

A

B

C

D

E

F

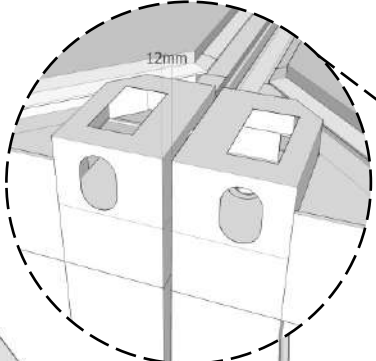

Maintain a 12mm gap between flatpack containers

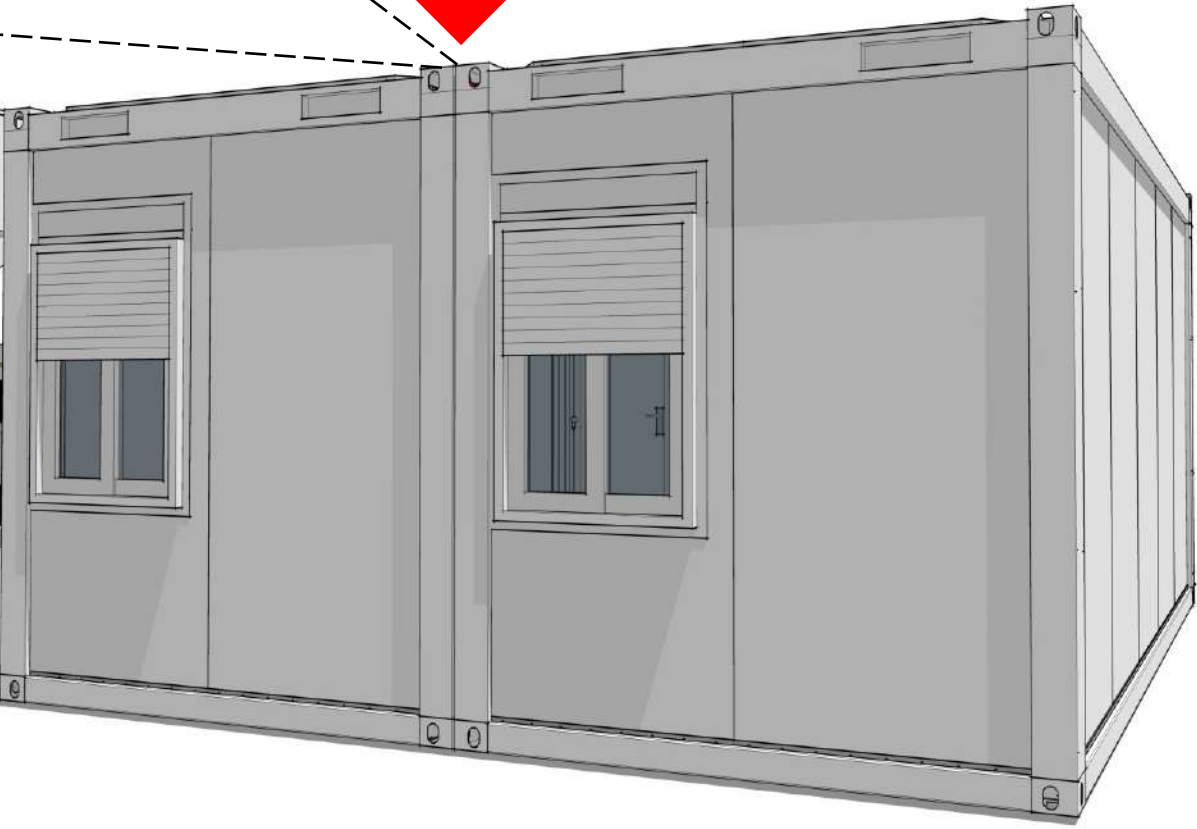
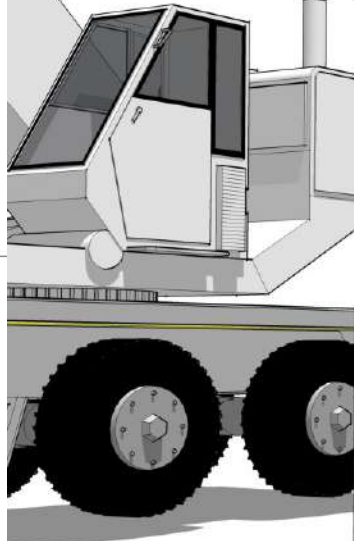

1 2 3 4 5 6 7

1 2 3 4 5 6 7 8

A
B
C
D
E
F

A
B
C
D
E
F

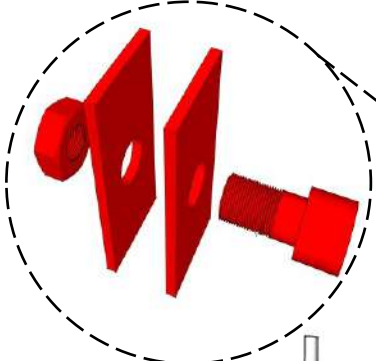

**Fix the connection plates on 4 corners.
Do not make it tight at this stage.**

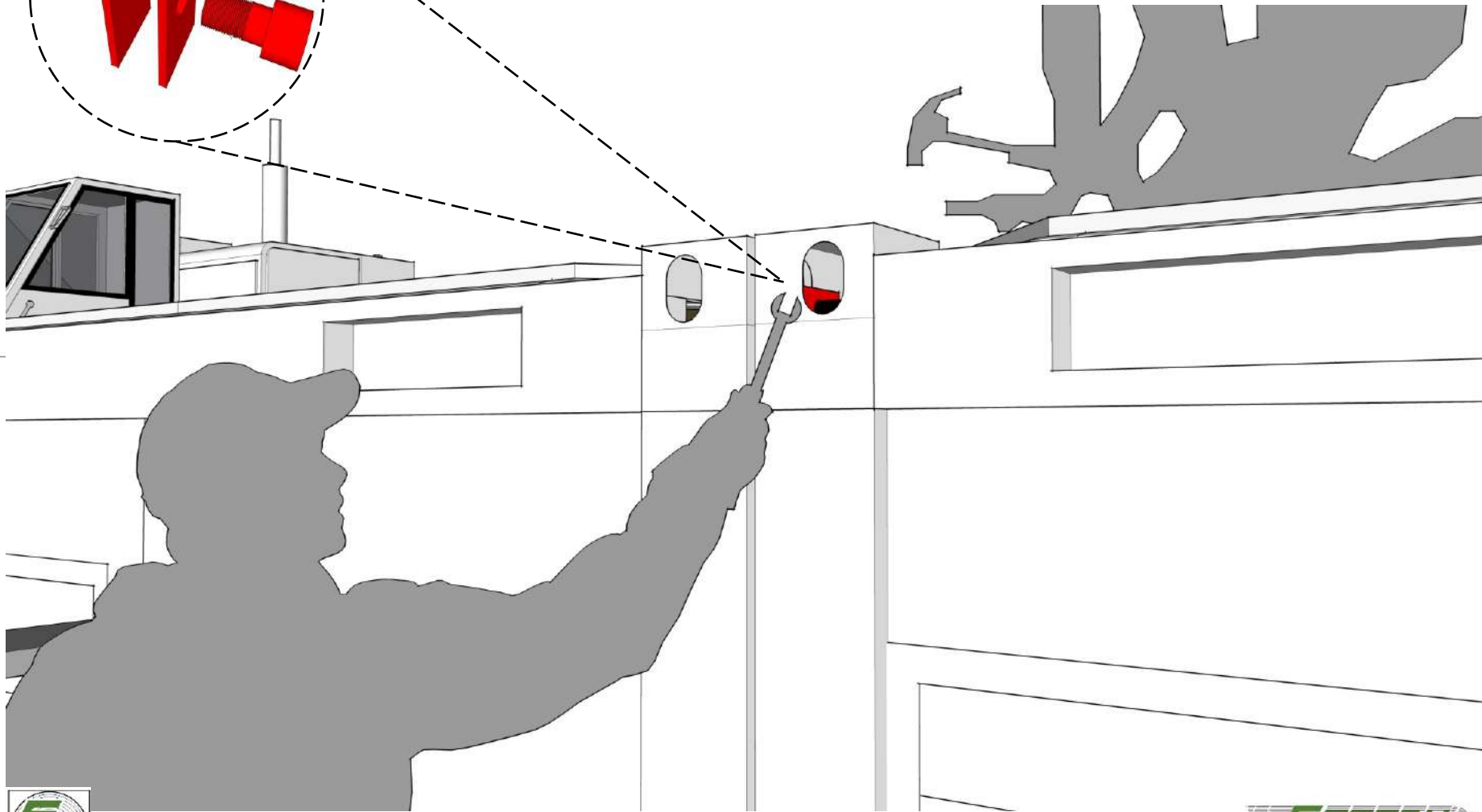

1 2 3 4 5 6 7 8

1

2

3

4

5

6

7

8

A

A

B

B

C

C

D

D

E

E

F

F

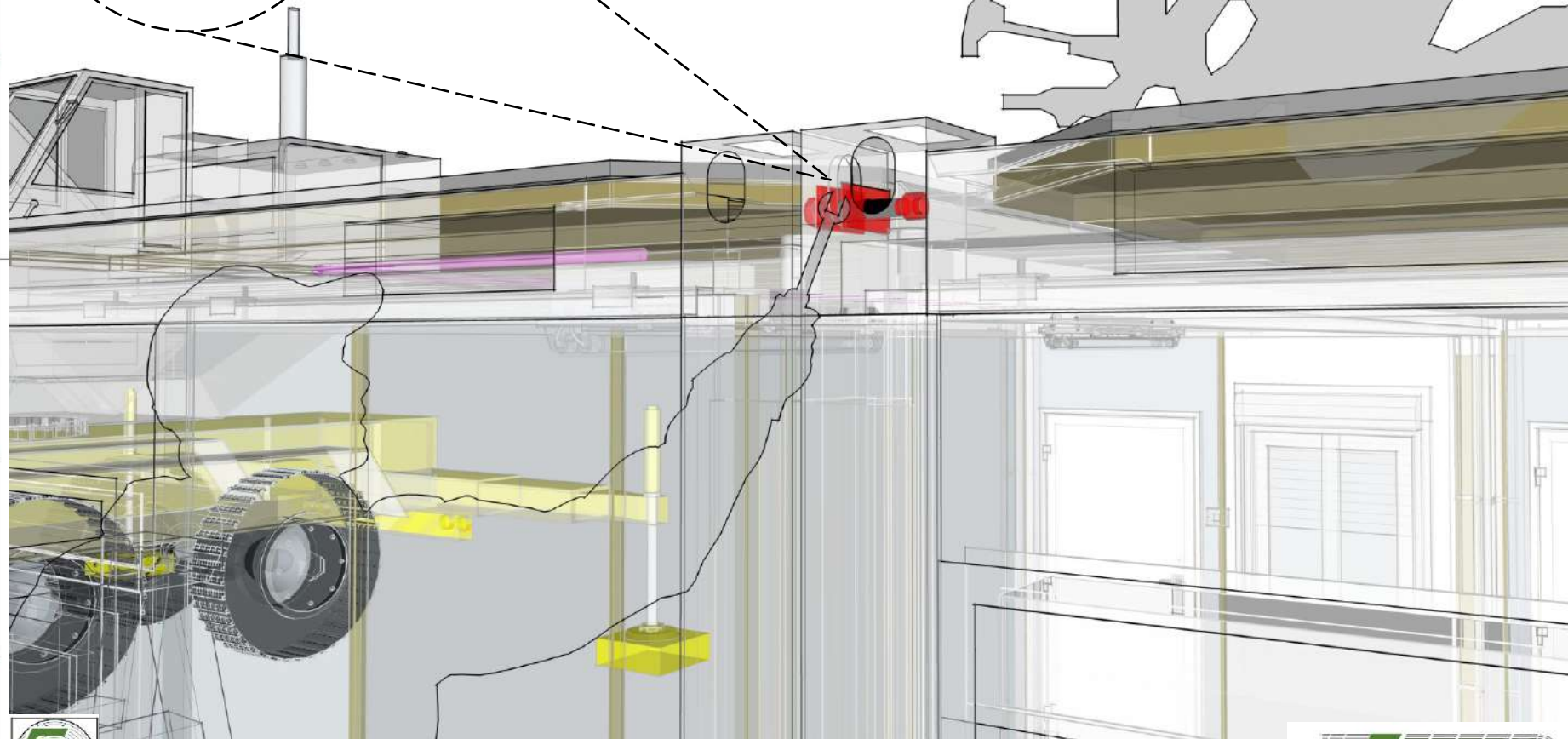
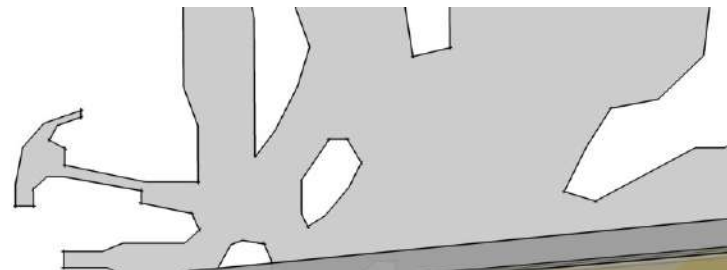
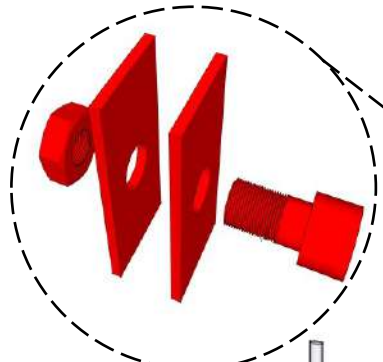

1

2

3

4

5

6

7

2 sets at top corners and 2 sets at bottom corners. Do not make it tight.

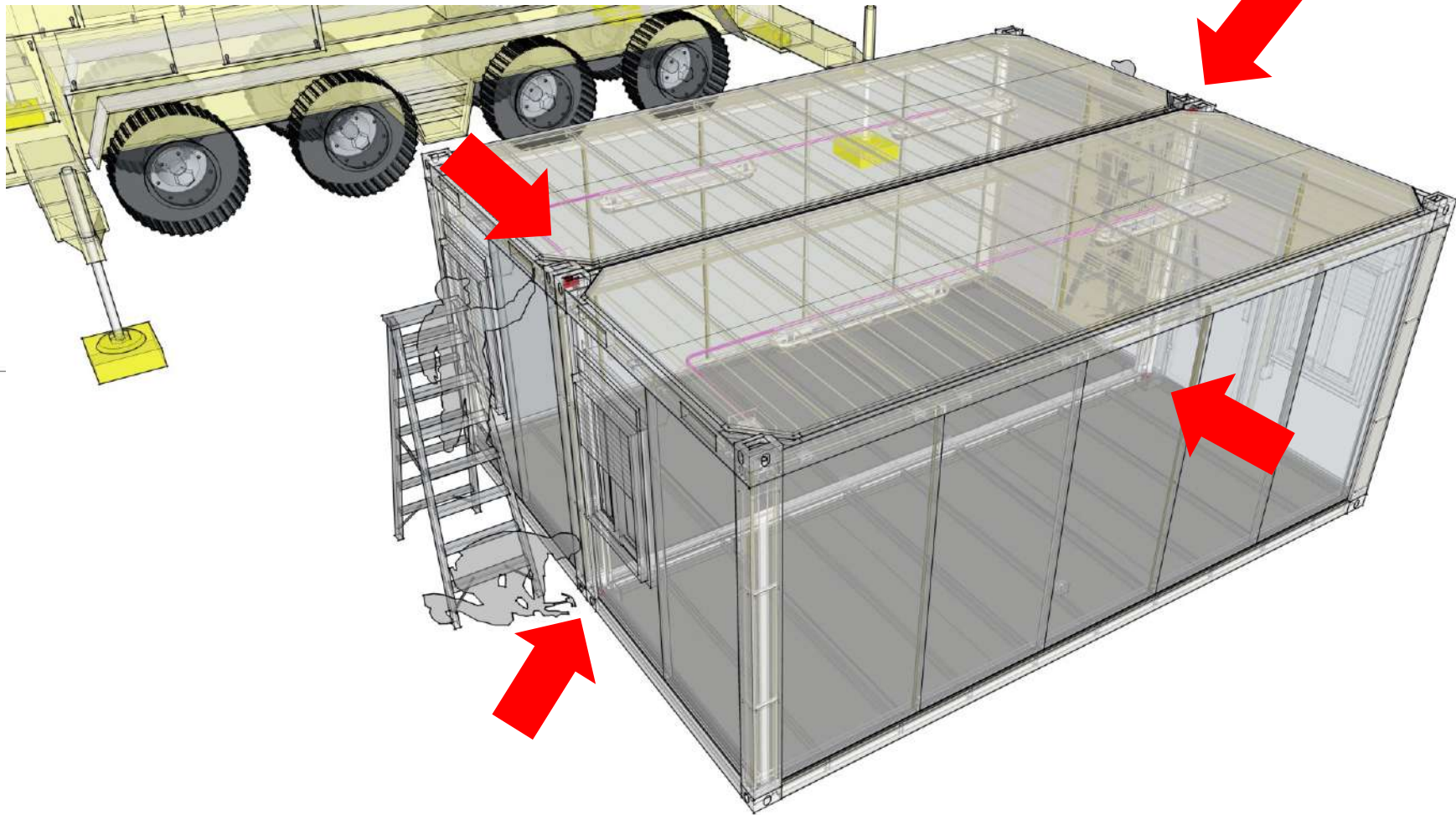

Note:

To avoid water leakage, use 1 pc 12m long sealing rubber all throughout the long side connection. No cut pieces.

Install the sealing rubber all throughout the long side connection. Use rubber hammer to push the rubber in place.

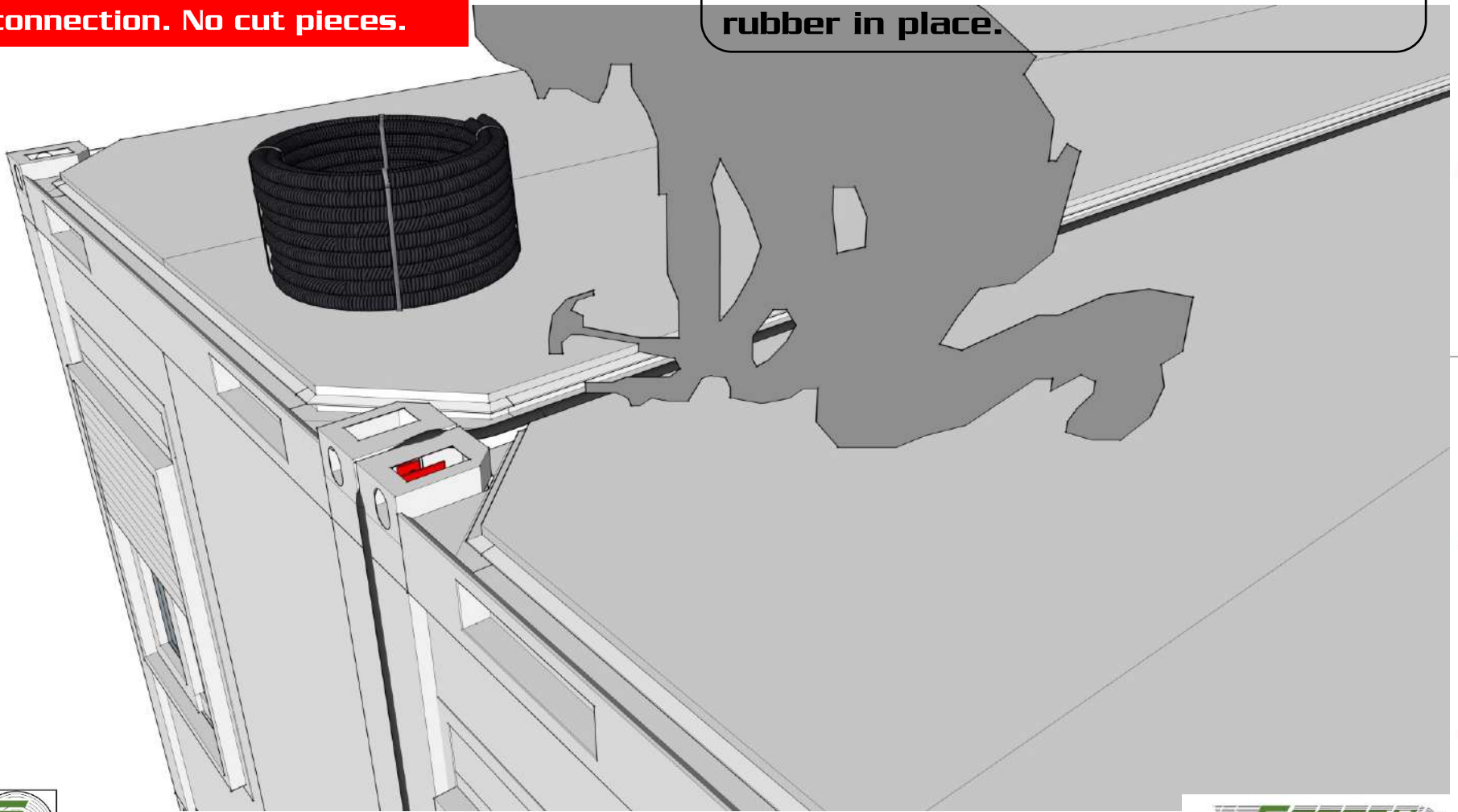

Note:
Make sure sealing rubber
goes around the top corner
as shown below.

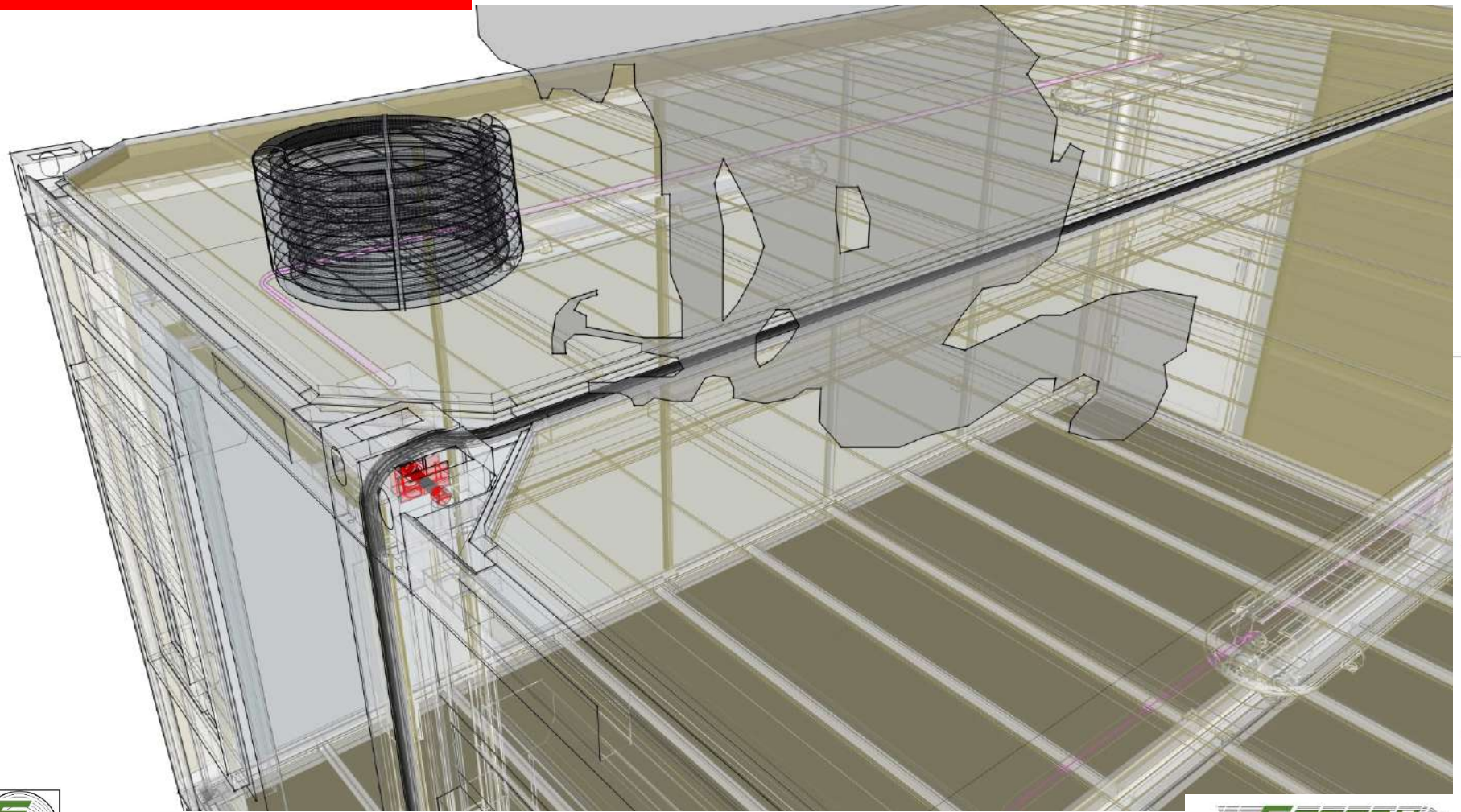

After sealing rubber is installed. Tighten all connection plates. Ensure to maintain consistent gap during tightening all throughout to avoid twisting of frames.

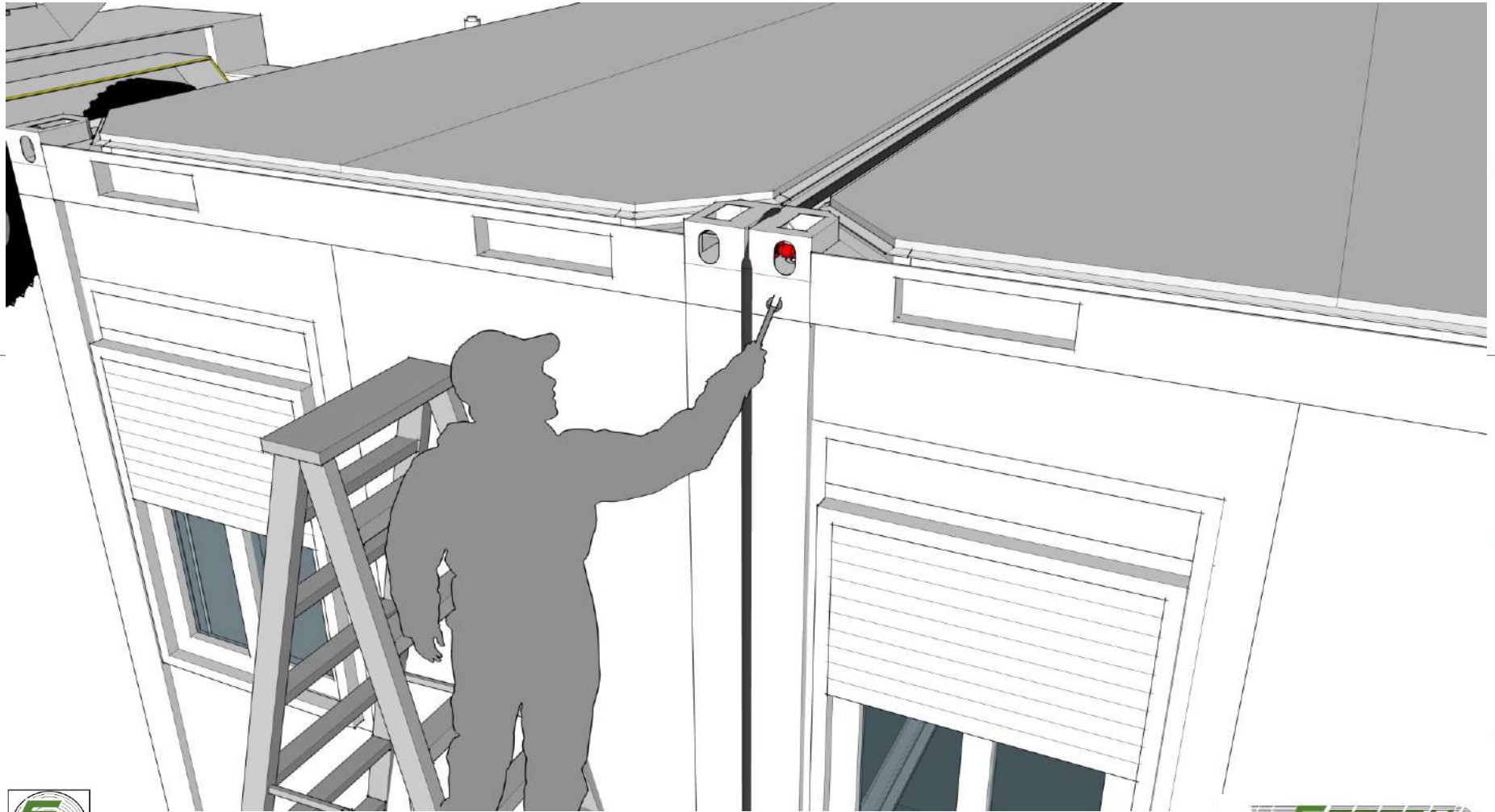

Connection on *long side*

Internal side

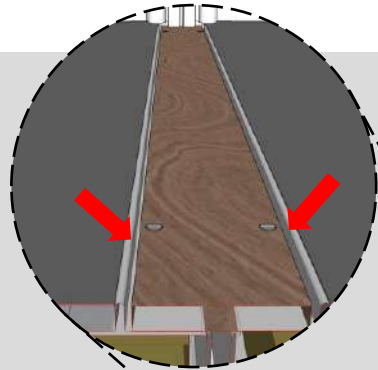

Install the plywood strip floor filler by screwing to floor frame. Center the plywood along the floor gap. There should be a sufficient gap between the plywood and the bump of the floor frame to install the aluminum floor connector trim.

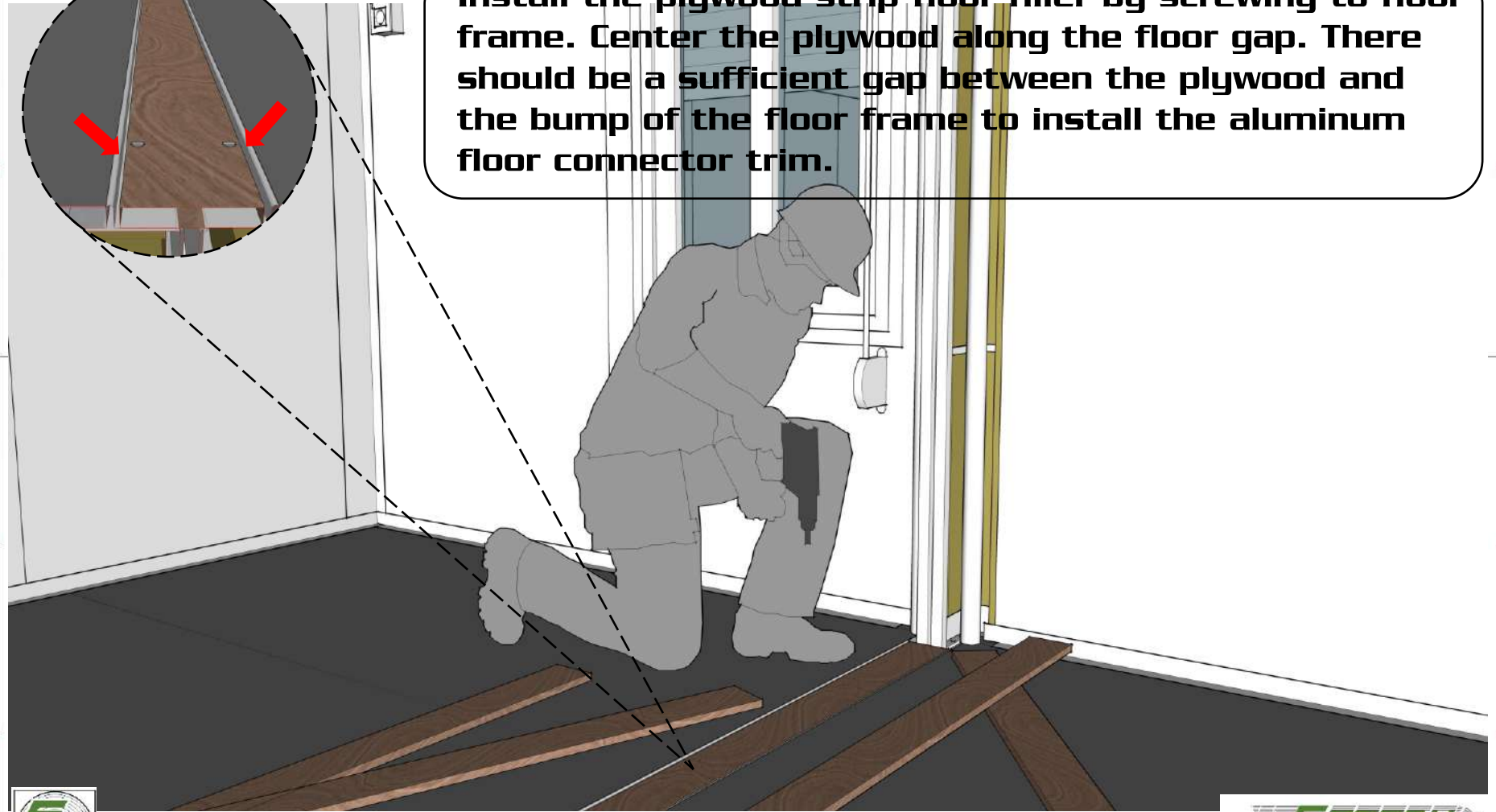

**There are 3 x pcs of Plywood strip
floor filler on long side**

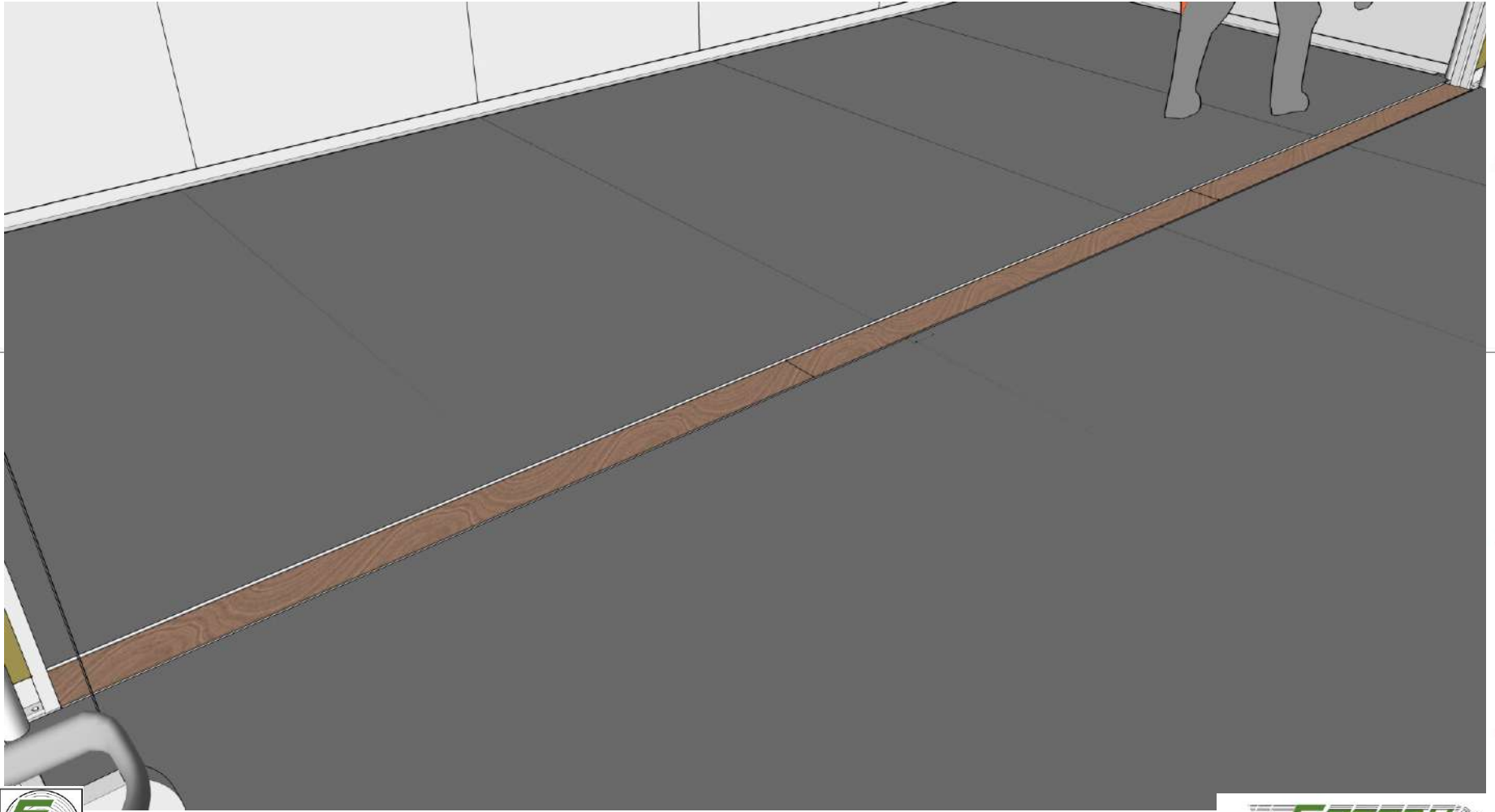

Fix the PVC roll floor strip on the plywood strip by glue.



Make sure to use 1 continuous piece of PVC roll floor strip.

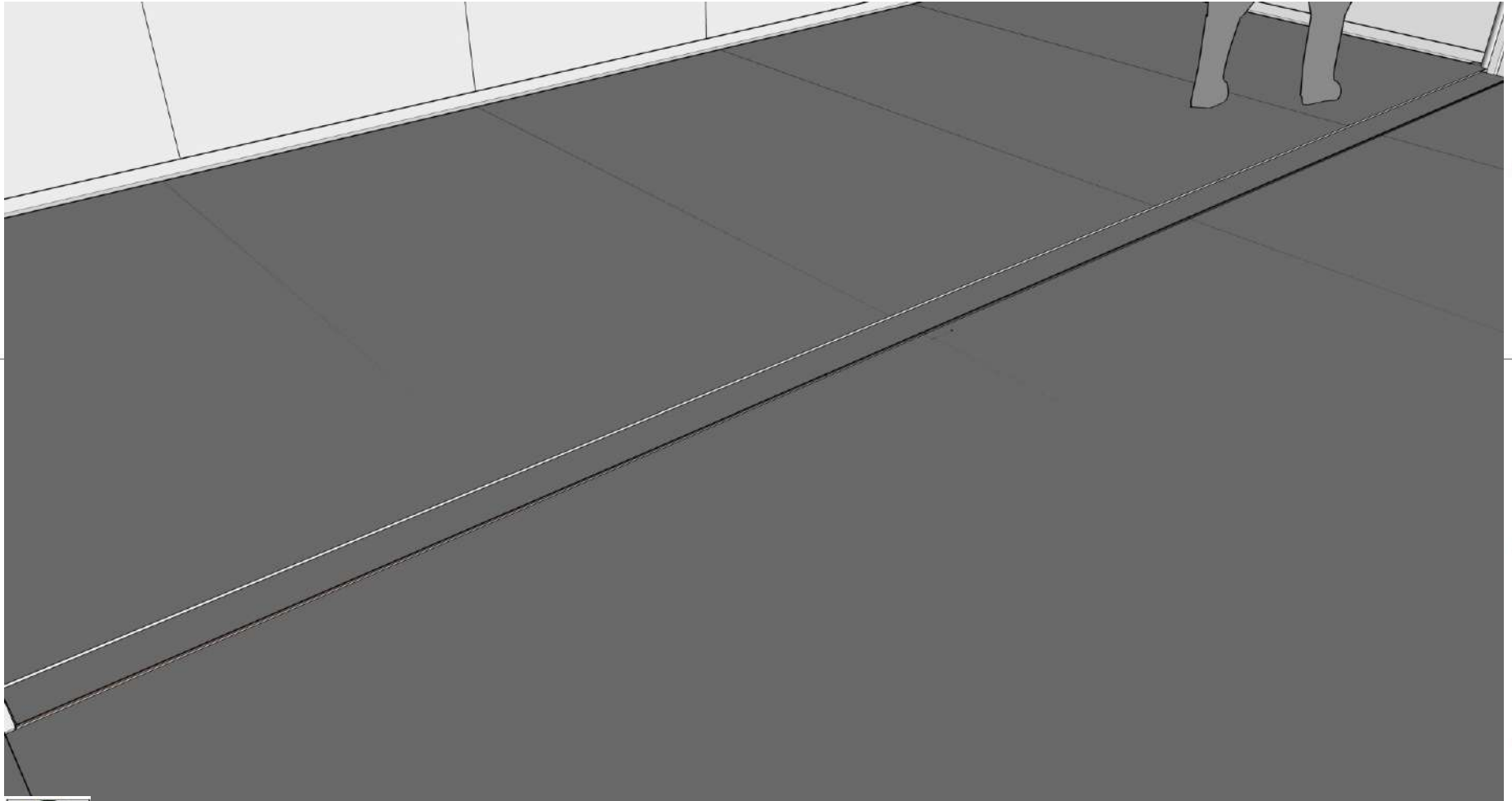

Install the Vertical flashing (cover inner post). Cut the top part to fit. Cutting can be done in the factory.

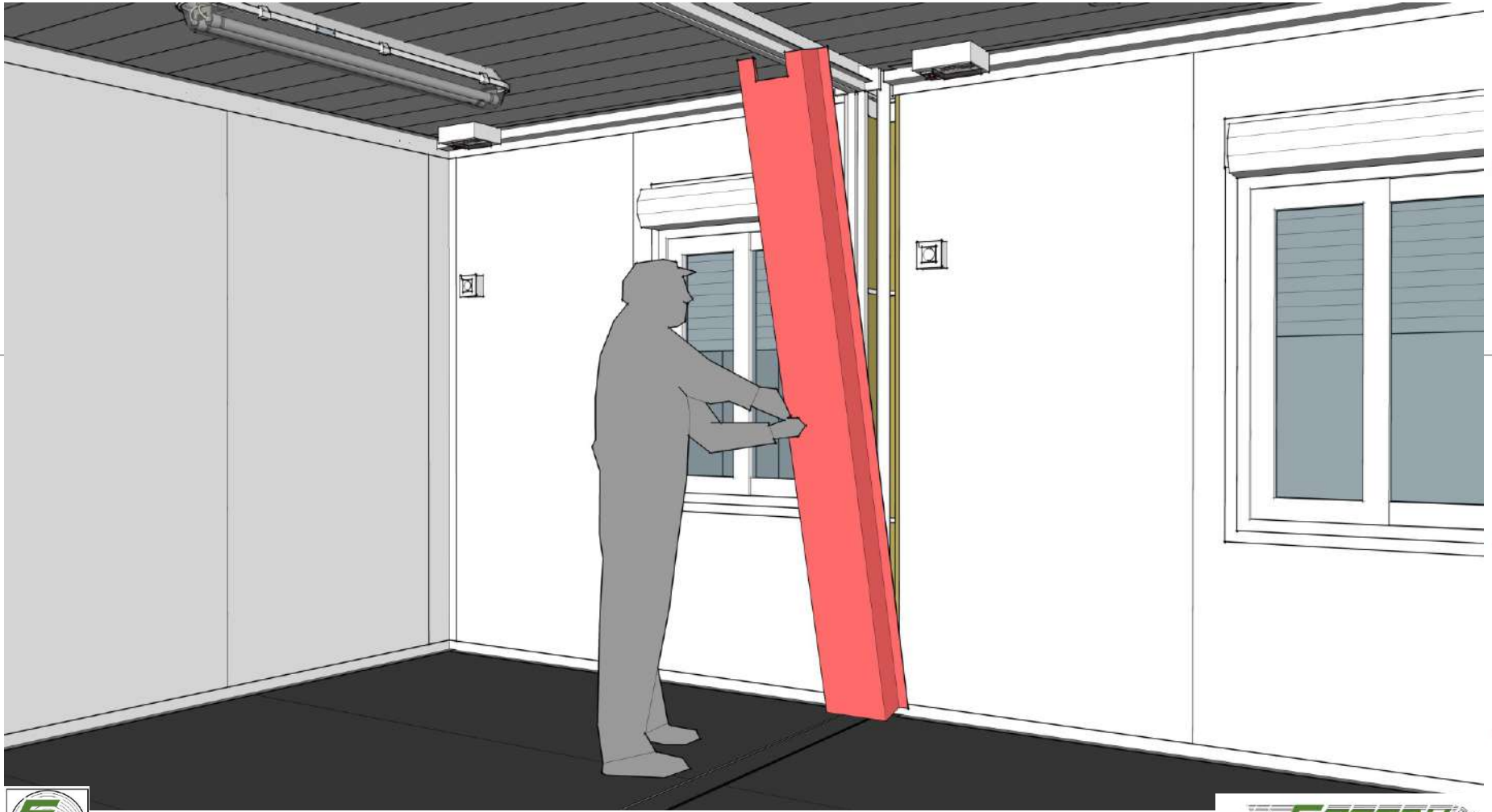

Install the Vertical flashing (to cover inner post). Cut the top part to fit. Also cutting can be done in the factory.

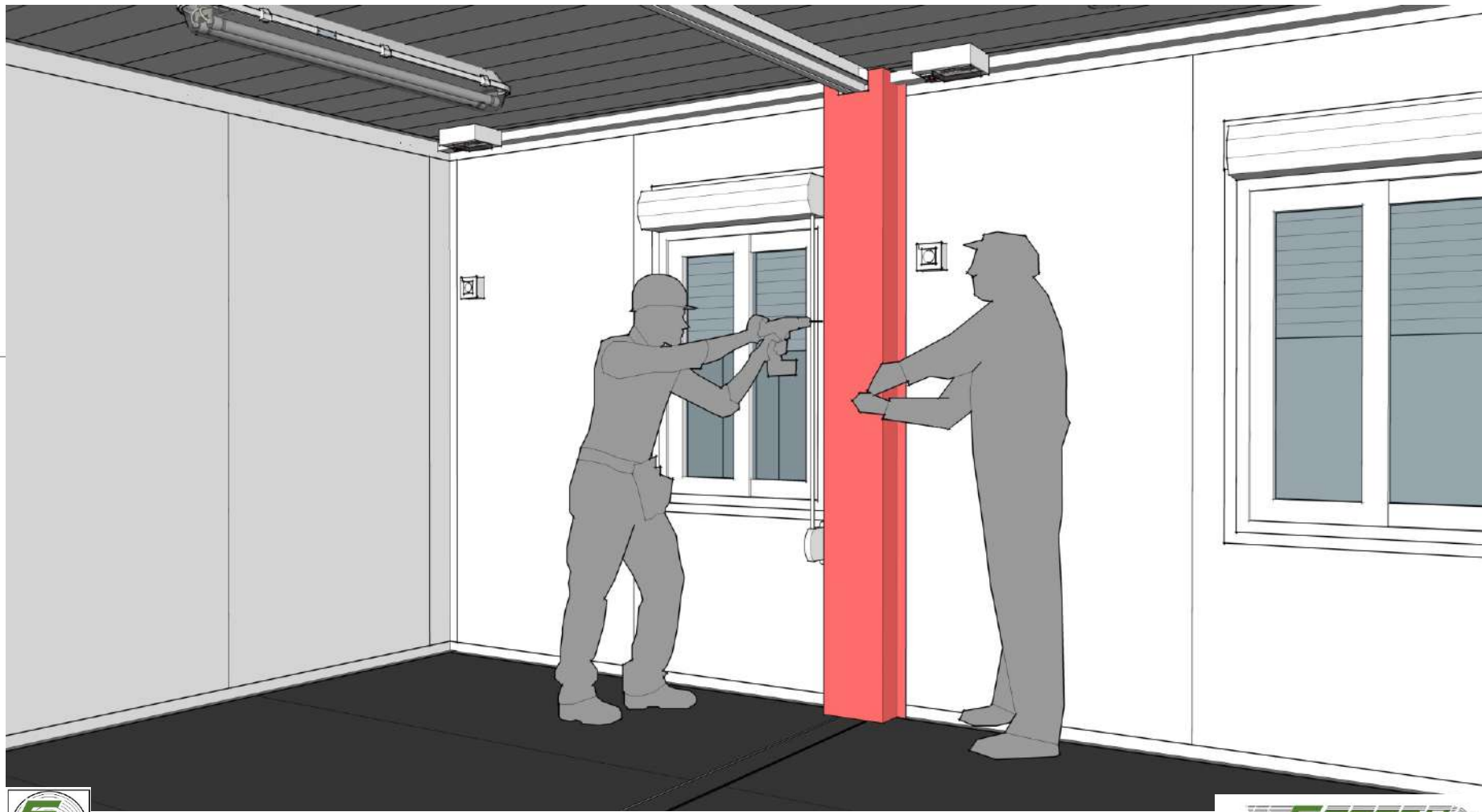

1

2

3

4

5

6

7

8

A

A

Install the all vertical flashing in 1 time.

B

B

C

C

D

D

E

E

F

F

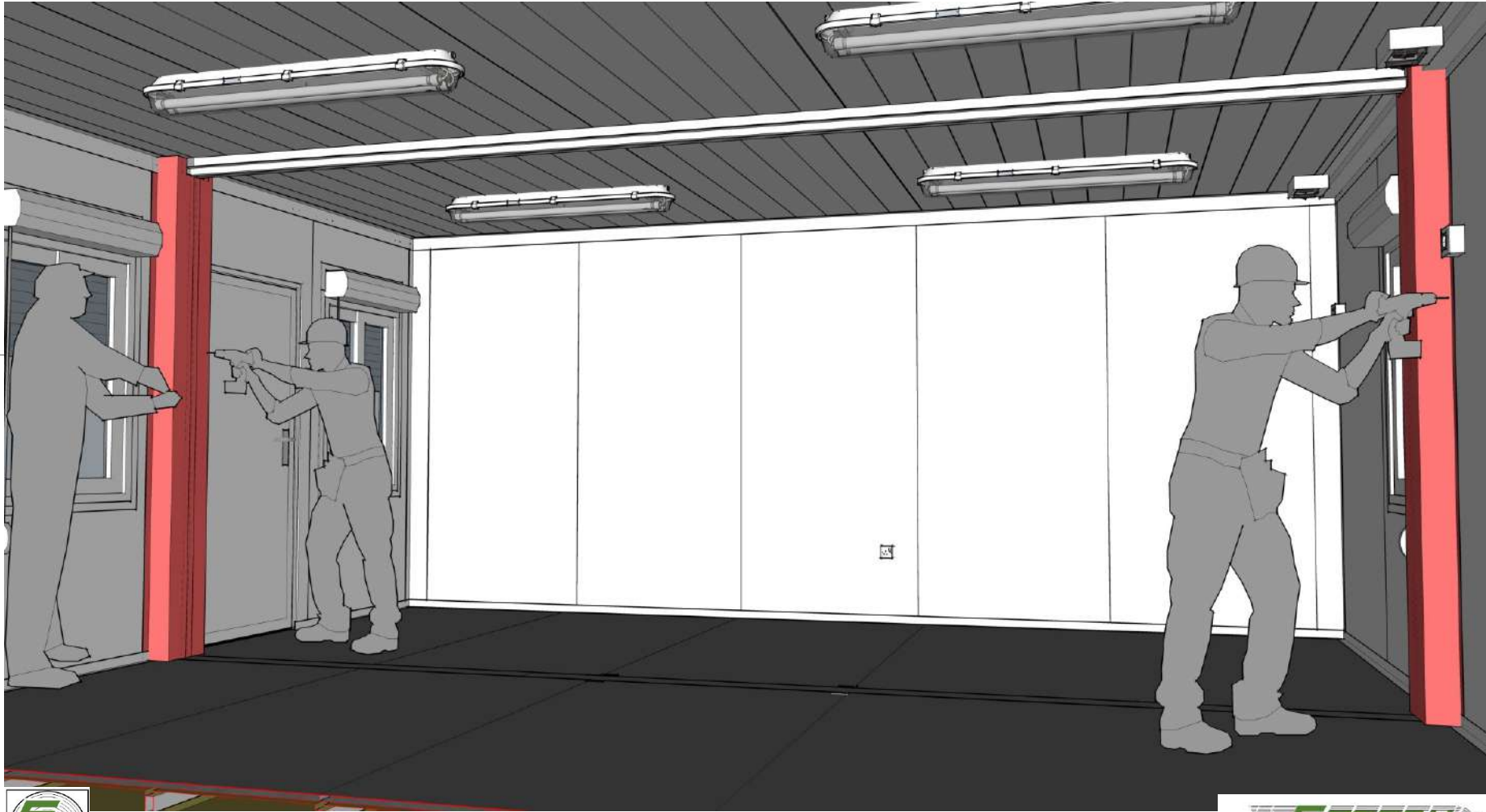

1

2

3

4

5

6

7

Next, install ceiling flashing. Make sure to get the center before fixing it by screw. Always start on 1 end.

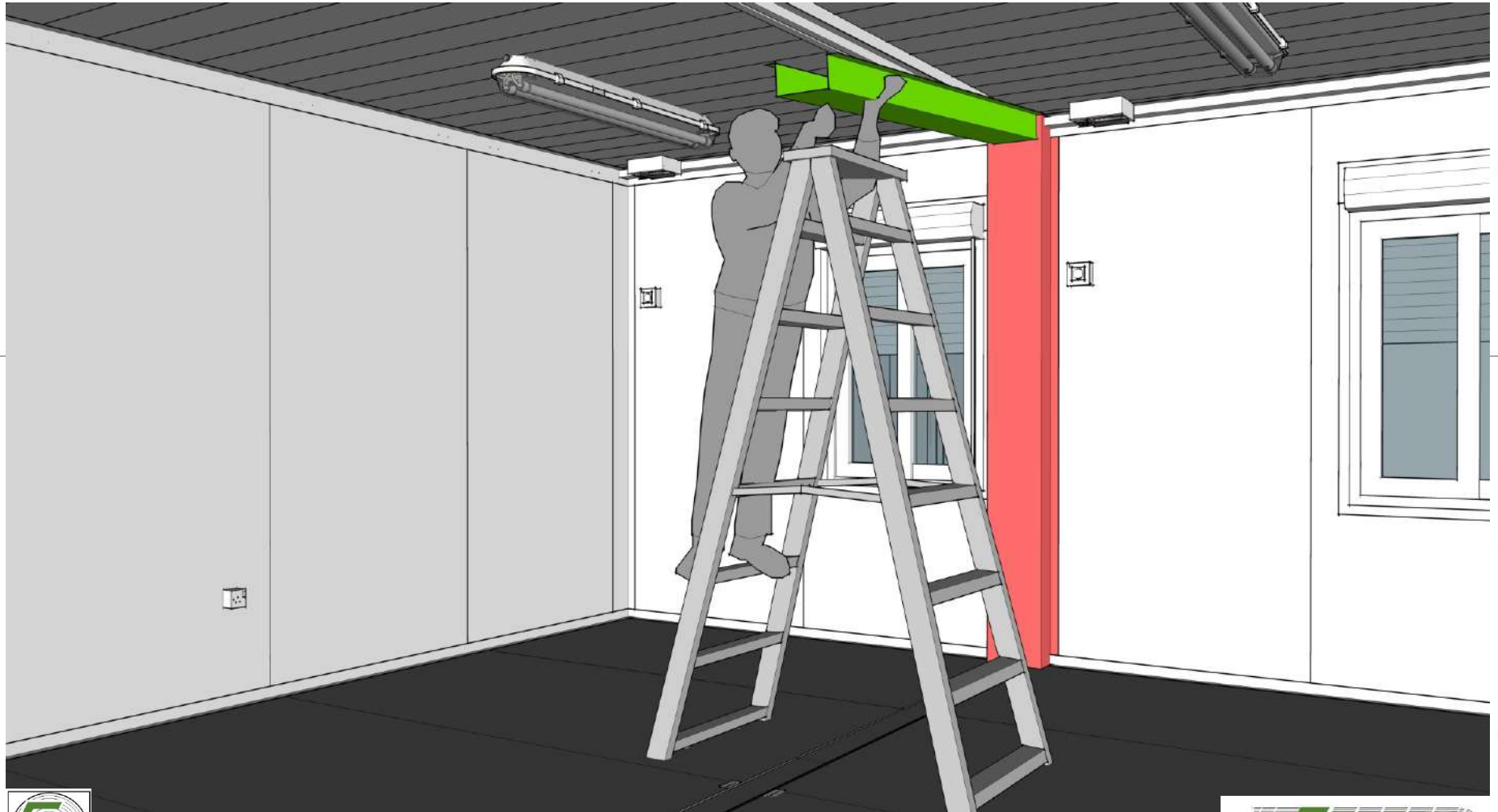

There are 3 pcs of ceiling flashing in long side



Install the aluminum floor connector trim. These are fix without screws. They are snap on

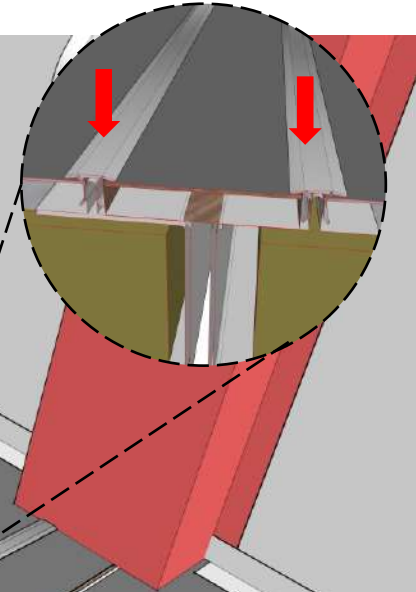

Push trim to the groove by using rubber hammer



Connection on long side

External side

**Sealing rubber/
gasket**

**Connection
plate set**



Connection on long side

Internal side

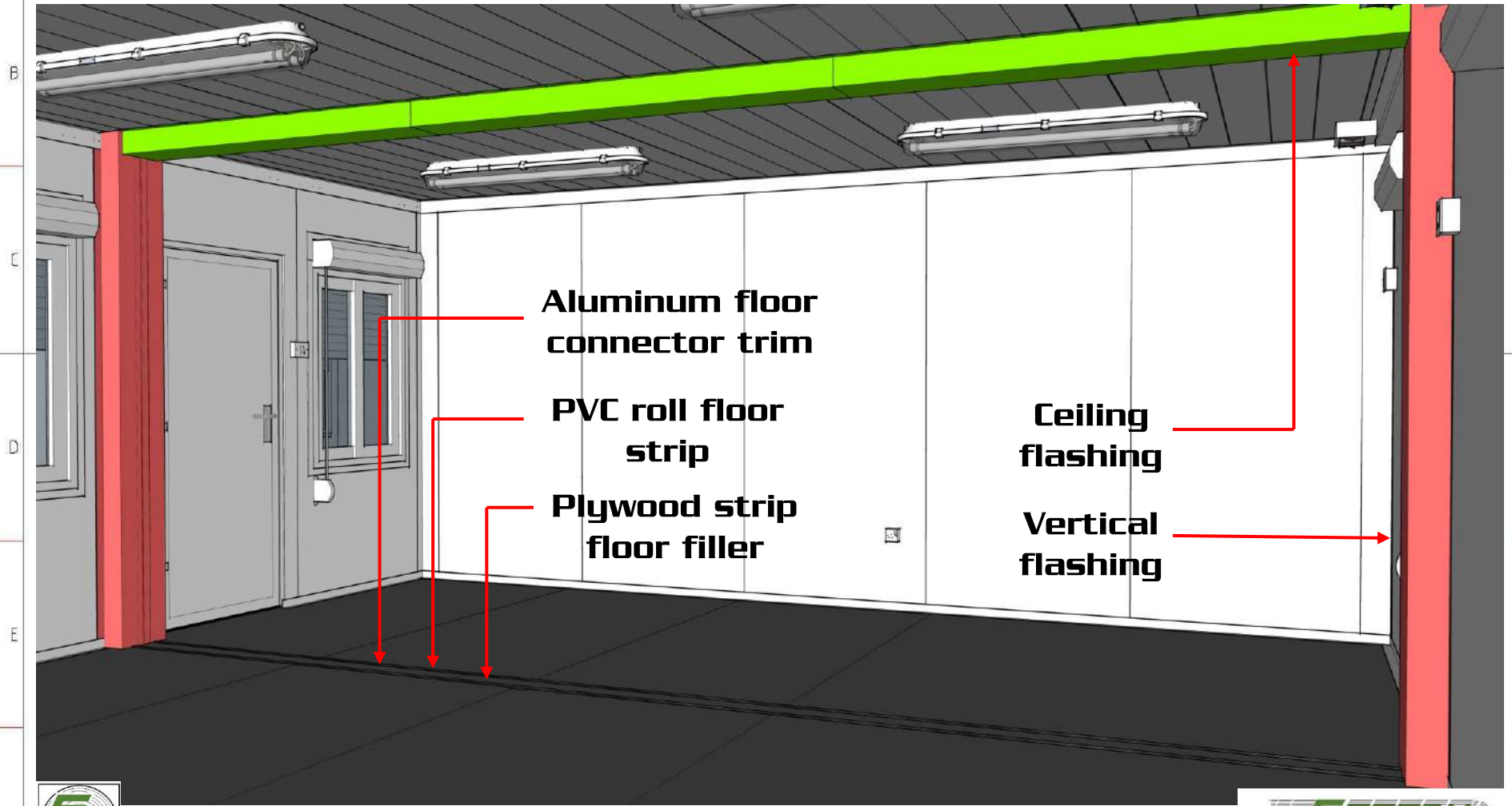

Lastly, install a rubber trim on all exposed **TOP** corner holes **ONLY**. This is to avoid overflowing on water on top corners in case of rain that will leave water stains on corner post paint.

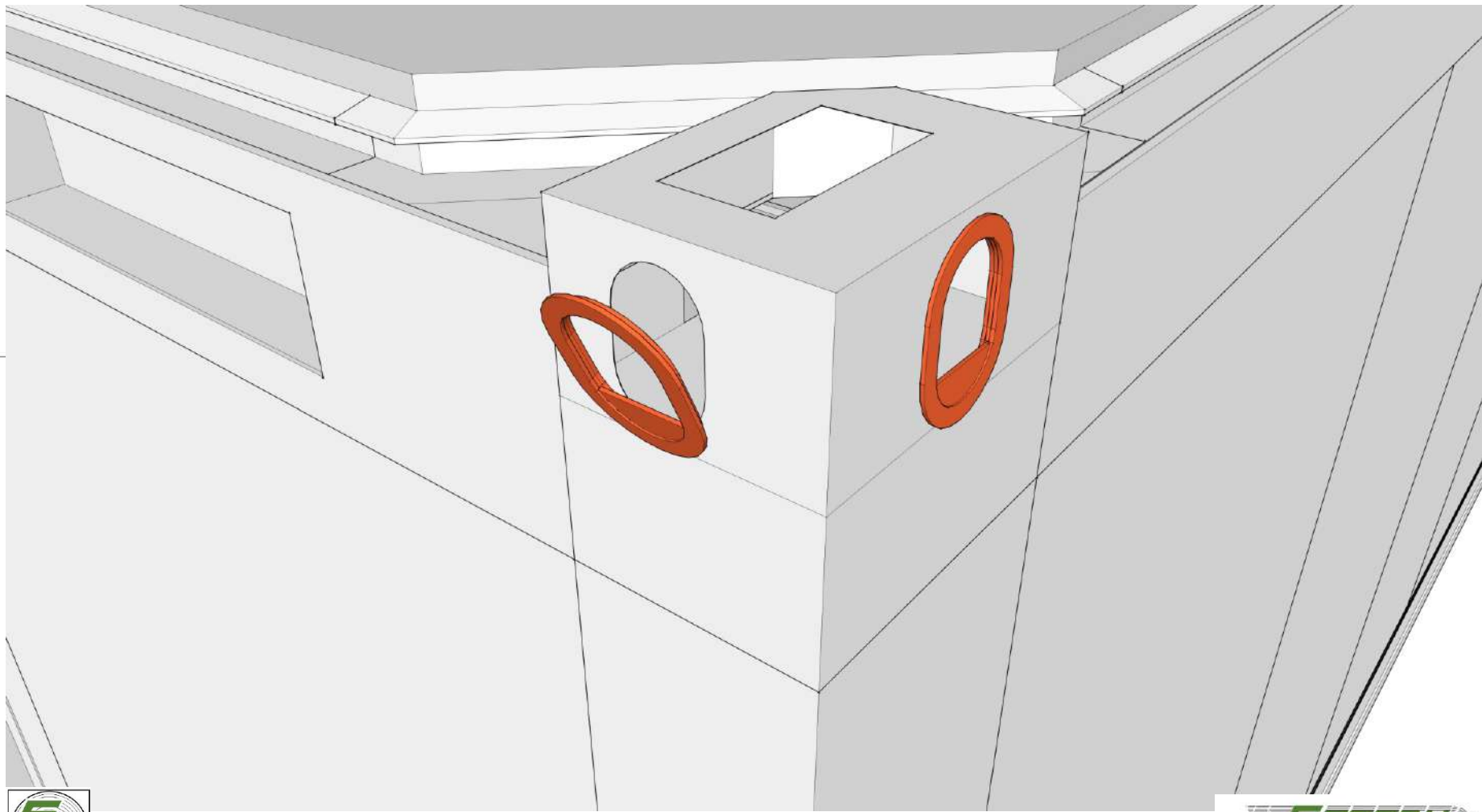

1

2

3

4

5

6

7

8

A

A

B

B

C

C

D

D

E

E

F

F

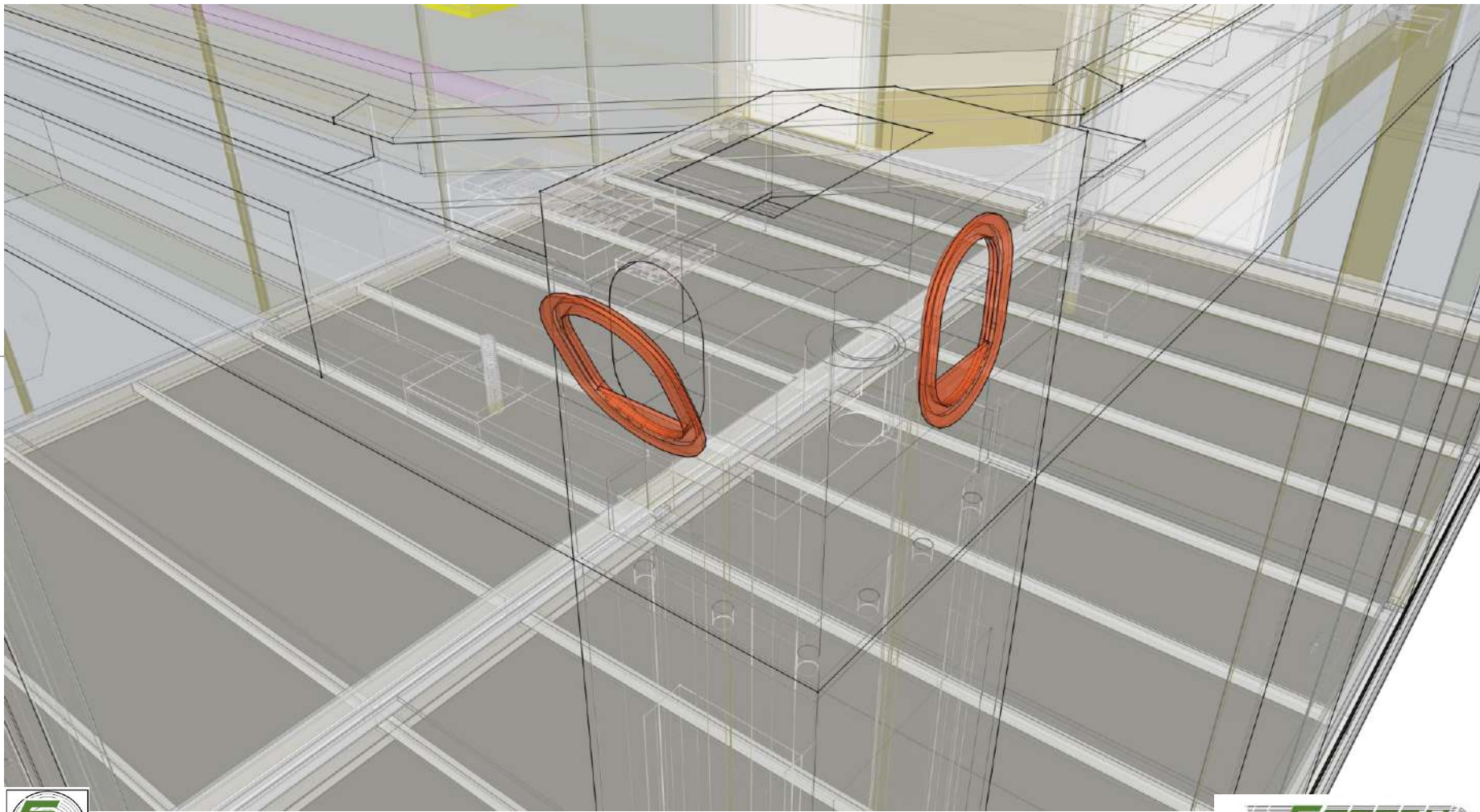

1

2

3

4

5

6

7

8

A

A

B

B

C

C

D

D

E

E

F

F

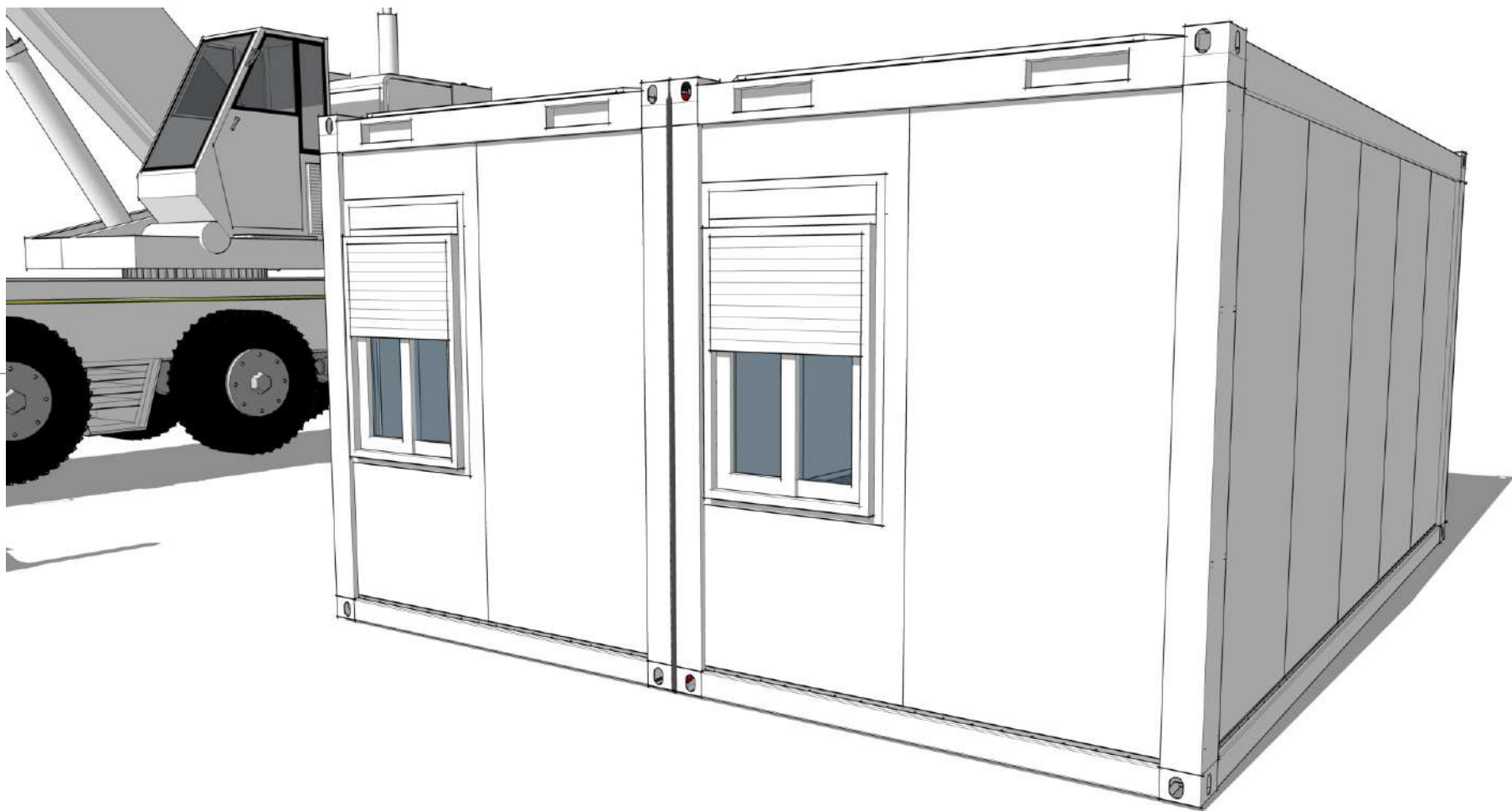

1

2

3

4

5

6

7

1

2

3

4

5

6

7

8

A

A

B

B

C

C

D

D

E

E

F

F

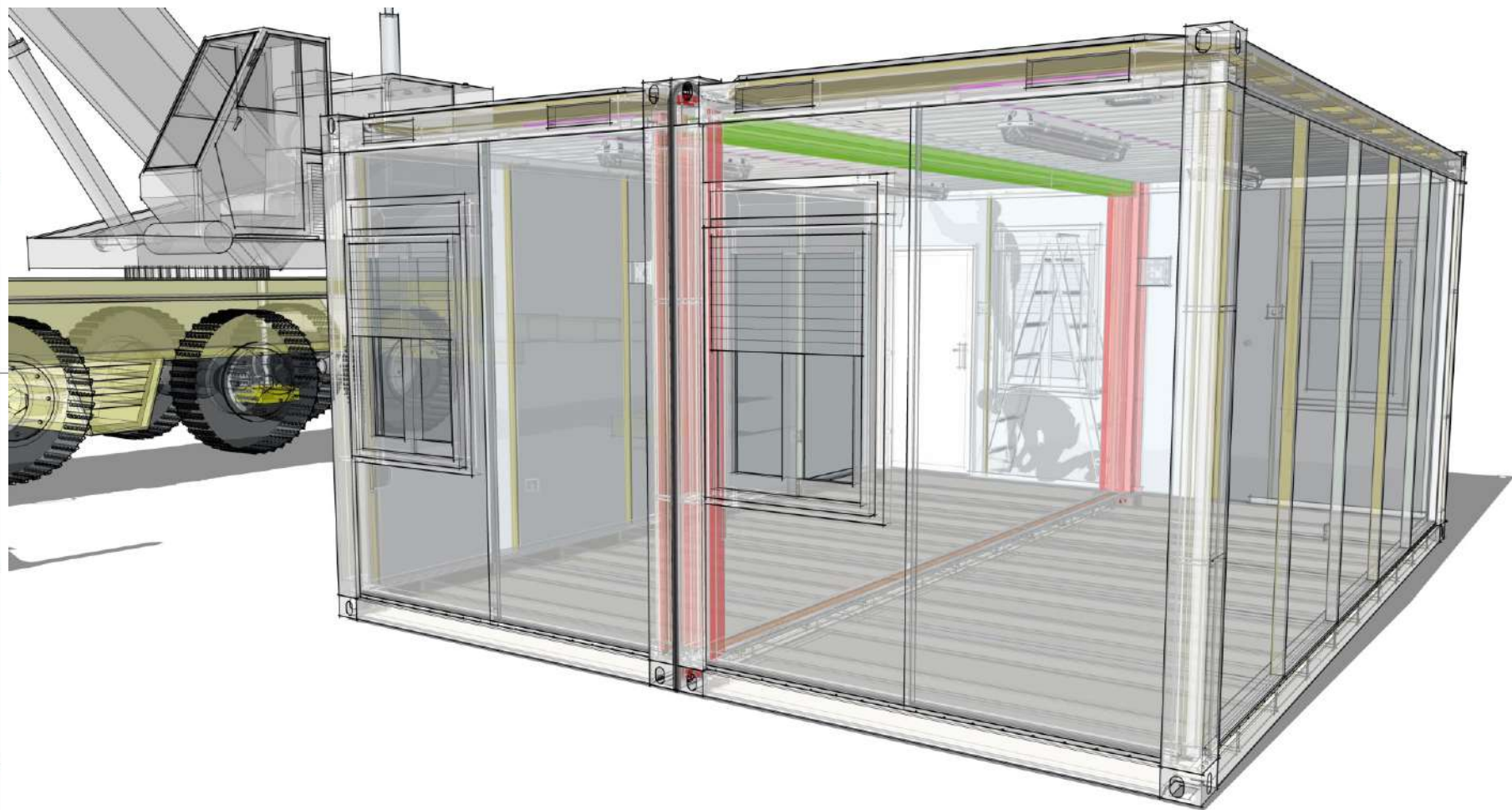

1

2

3

4

5

6

7

1

2

3

4

5

6

7

8

A

A

B

B

C

C

D

D

E

E

F

F

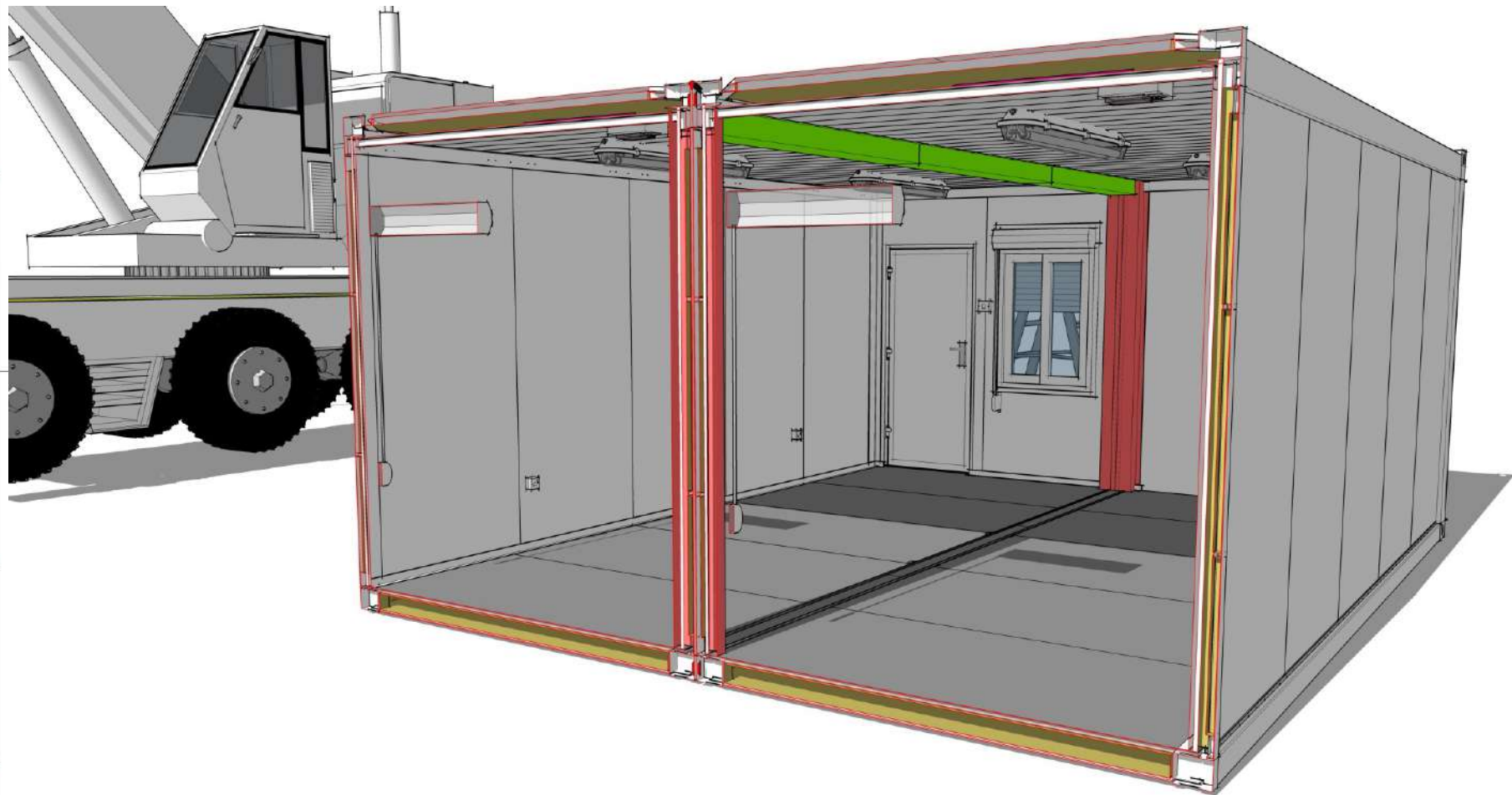

1

2

3

4

5

6

7